

The following pages (59 – 62) detail the products required to install a 'cable and wire' lightning protection system. Additionally, accessories can be found on pages 63 – 64.

Details of the cable and wire conductors can be found in the Conductors section.

## Air rod

| Rod length | Rod diameter | Thread diameter | Material | Weight each | Part No.         |
|------------|--------------|-----------------|----------|-------------|------------------|
| 500mm      | 15mm         | 16mm            | Copper   | 0.73kg      | RA215            |
| 1000mm     | 15mm         | 16mm            | Copper   | 1.51kg      | RA225            |
| 1500mm     | 15mm         | 16mm            | Copper   | 2.35kg      | RA230 <b>NEW</b> |
| 2000mm     | 15mm         | 16mm            | Copper   | 3.00kg      | RA240            |
| 3000mm     | 15mm         | 16mm            | Copper   | 4.70kg      | RA250 <b>NEW</b> |

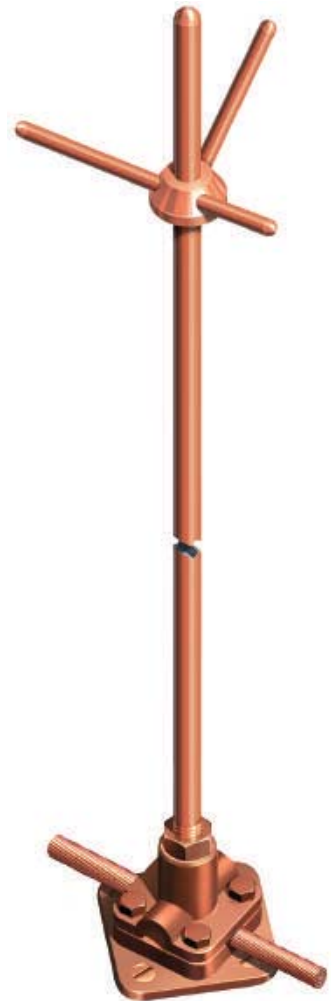

Manufactured from high conductivity hard drawn copper, with rolled threads. Supplied complete with locknut.

*"Field Trials in the United States, carried out over many years research have confirmed that blunt air rods are struck by lightning in preference to taper pointed air rods."*

"Lightning rod improvement studies" by C B Moore, W Rison, J Mathis, G Aulich. Journal of Applied Meteorology, May 2000.

Note: during high winds and extreme weather conditions air rods over 1000mm long can be subjected to fatigue mechanisms. It is therefore recommended that additional supports are considered before installation.



BS EN 50164-2

## Multiple point

| Rod diameter | Material | Weight each | Part No. |
|--------------|----------|-------------|----------|
| 15mm         | Copper   | 0.27kg      | RA600    |

Manufactured from high conductivity hard drawn copper, suitable for use with copper air rods only.

## Flat saddle

| Conductor size | Rod diameter | Thread diameter | Conductor material | Weight each | Part No. |
|----------------|--------------|-----------------|--------------------|-------------|----------|
| 50mm           | 15mm         | 16mm            | Copper             | 1.03kg      | SD155    |
| 70mm           | 15mm         | 16mm            | Copper             | 0.95kg      | SD160    |
| 95mm           | 15mm         | 16mm            | Copper             | 0.95kg      | SD165    |



Manufactured from a high quality copper alloy. Simple to install, providing an effective connection between air rod and stranded air termination conductors.



BS EN 50164-1 Class H



Fix using countersunk wood screws 1½" No. 10 or M6 (Part no. SW005) and wall plugs (Part no. PS305) – see Accessories page 63.



Tightening torque 12Nm

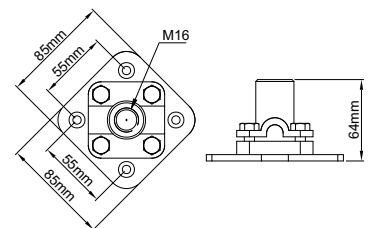

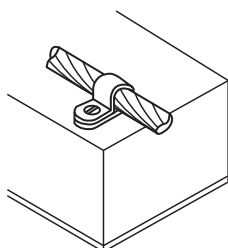
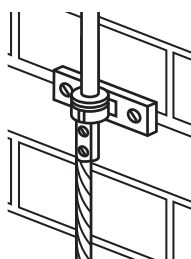
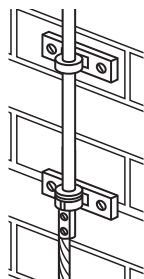

## Rod brackets

| Rod diameter | Rod material | Weight each | Part No. |
|--------------|--------------|-------------|----------|
| 15mm         | Copper       | 0.90kg      | BR105    |

Manufactured from high quality copper alloy. Simple to install, providing an effective means of mounting an air rod on a vertical surface e.g. a chimney stack. Use in conjunction with the rod to cable coupling.



Fix using roundhead wood screws 1½" No. 12 or M8

## Rod to cable coupling

| Rod diameter | Thread diameter | Conductor size         | Conductor material | Weight each | Part No. |
|--------------|-----------------|------------------------|--------------------|-------------|----------|
| 15mm         | 16mm            | 50 – 70mm <sup>2</sup> | Copper             | 0.25kg      | CG705    |
| 15mm         | 16mm            | 95mm <sup>2</sup>      | Copper             | 0.25kg      | CG710    |

Manufactured from high quality copper alloy. Provides an effective connection between air rod and stranded air termination conductor. Use in conjunction with rod brackets.



BS EN 50164-1 Class H



Tightening torque 6Nm

## One hole cable clip

| Conductor size    | Conductor material | Weight each | Part No. |
|-------------------|--------------------|-------------|----------|
| 50mm <sup>2</sup> | Copper             | 0.01kg      | CP910    |
| 70mm <sup>2</sup> | Copper             | 0.01kg      | CP915    |
| 95mm <sup>2</sup> | Copper             | 0.01kg      | CP920    |

Manufactured from pure copper, these simple pressed clips are available to suit a range of stranded copper conductors.



Fix using roundhead wood screws 1½" No. 10 or M6 (Part no. SW305) and wall plugs (Part no. PS305) – see Accessories page 63.

### Heavy duty cast cable saddle

| Conductor size    | Conductor material | Weight each | Part No. |
|-------------------|--------------------|-------------|----------|
| 50mm <sup>2</sup> | Copper             | 0.10kg      | CP810    |
| 70mm <sup>2</sup> | Copper             | 0.10kg      | CP815    |
| 95mm <sup>2</sup> | Copper             | 0.10kg      | CP835    |

Manufactured from high quality copper alloy. Simple to install, providing an effective fixing for stranded copper cables.



Fix using countersunk wood screws 1½" No. 10 or M6 (Part no. SW005) and wall plugs (Part no. PS305) – see Accessories page 63.

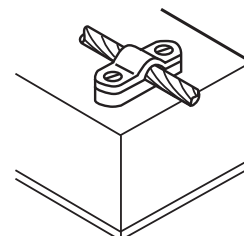

### Test clamp

| Conductor size    | Conductor material | Weight each | Part No. |
|-------------------|--------------------|-------------|----------|
| 50mm <sup>2</sup> | Copper             | 0.39kg      | CR855    |
| 70mm <sup>2</sup> | Copper             | 0.40kg      | CR860    |
| 95mm <sup>2</sup> | Copper             | 0.40kg      | CR865    |

Manufactured from high quality copper alloy. Simple to install, providing an effective low resistance overlap connection between stranded copper cables.



BS EN 50164-1 Class H



Fix using countersunk wood screws 1½" No. 10 or M6 (Part no. SW005) and wall plugs (Part no. PS305) – see Accessories page 63.



Tightening torque 12Nm

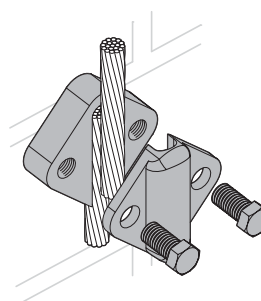

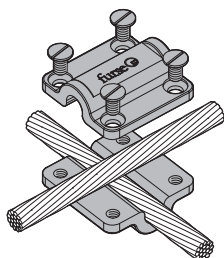

## Square conductor clamp

| Conductor size    | Conductor material | Weight each | Part No.     |
|-------------------|--------------------|-------------|--------------|
| 50mm <sup>2</sup> | Copper             | 0.32kg      | <b>CR810</b> |
| 70mm <sup>2</sup> | Copper             | 0.29kg      | <b>CR815</b> |
| 95mm <sup>2</sup> | Copper             | 0.25kg      | <b>CR820</b> |

Manufactured from high quality copper alloy. Simple to install, providing an effective low resistance connection between overlapping stranded conductors allowing cross, tee, through and right angle joints to be formed.



BS EN 50164-1 Class H



Tightening torque 6Nm

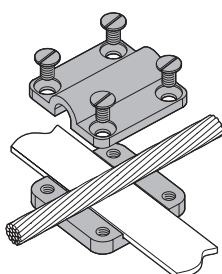

## **NEW** Cable to tape square clamp

| Conductor size                | Conductor material | Weight each | Part No.     |
|-------------------------------|--------------------|-------------|--------------|
| 25 x 3mm to 70mm <sup>2</sup> | Copper             | 0.30kg      | <b>CT130</b> |

Manufactured from high quality copper alloy. Simple to install, providing an effective low resistance connection between conductor tape and stranded copper conductor.



BS EN 50164-1 Class H



Fix using countersunk wood screws 1½" No. 10 or M6 (Part no. **SW005**) and wall plugs (Part no. **PS305**) – see Accessories page 63.



Tightening torque 5Nm